

US150

US150

Ø 150 - 610 mm (5.906" - 24")



DESCRIPTION :

The US150 heavy duty beveler is a robust and portable machine allowing to perform repeatable, high quality weld end preparation works on metal pipes including mild, chrome, stainless steel, duplex, super duplex, coppernickel alloy steel, inconel, P91, aluminium, copper and exotic alloys.

The US 150 covers diameters ranging from 150 mm (5.906") ID to 508 mm (20") OD. This machine can also be delivered with its 610 mm (24") tool holder plate.

It can be either pneumatically or electrically or hydraulically driven.

The standard tool plate will accept multiple tool bits, allowing up to four simultaneous machining operations. Such operations may include 30°, 37°30, 45° bevels with or without land, J-bevels, compound bevels, facing, counterboring works etc..

The tool bits can be changed and adjusted very quickly. Carbide tool inserts can alternatively be used.

Easy to use, robust and versatile, the US 150 will allow you to optimize your tube and pipe welding preparations !



US150 with pneumatic drive

OD MOUNT MACHINING

Beveling	Cutting	Facing	Counterboring	Surfacing
✓	✗	✓	✓	✗

DIMENSIONS VIEW 1 :

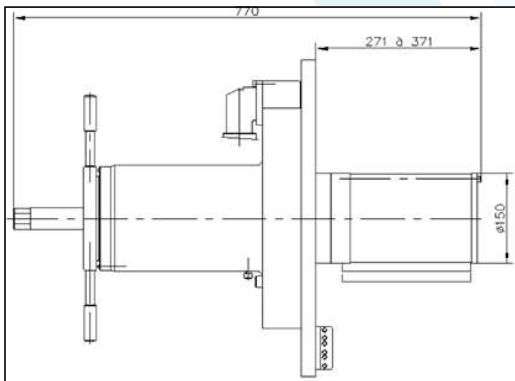

DIMENSIONS VIEW 2 :

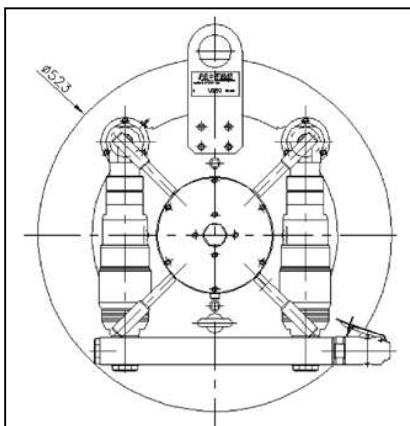

TECHNICAL FEATURES

Machine	US150
Machining Capacity	Standard model:
	150 mm (5.906") ID
	508 mm (20") OD
	With options:
	150 mm (5.906") ID
	920 mm (36.220") OD
Clamping capacity	150 mm (5.906") ID 508 mm (20") OD
Specific shapes & angles	Facing, 30°, 37°30, 45° bevel, counterbore, J-bevel, others on request
Clamping	Manual with key
Feed stroke	100 mm (3.937")
Expansion	30 mm (1.181")
Cutting head gear drive	10 rpm off-load speed, 7 rpm nominal speed
Drive Power	Pneumatic, hydraulic or electric
	Dual pneumatic drive 2 x 1.47 kW, 6 bar (87 psi), 2 x 1800 l/min (2 X 63 cfm)
	Electric drive 2200 W
<i>Pneumatic driven machines have to be used with a lubricating filter. Recommended option: regulation valve.</i>	

ORDER NO.	DESCRIPTION
US150	US150 with pneumatic drive: standard version with dual pneumatic drive 2 x 1,47 kW, weight ~ 85 kg/ 187,4 lbs
US150E	US150 with electric drive 2800 W, weight ~ 145kg/ 319,7 lbs
US150HY	US150 with dual hydraulic drive, weight ~ 95 kg/209,4 lbs
US150HY-SD	US150 with single hydraulic drive, weight ~ 88 kg/194 lbs
US150DSB	US150DSB Beveling machine with dual pneumatic drive and dual bearing .Higher accuracy. For options US150-ASB, US150-KS75-30, US150-KS75-36, weight ~ 90 kg/ 198,4 lbs
US150DSB-HY-SD	US150DSB-HY-SD Beveling machine with single hydraulic drive and dual bearing + regulation valve. Higher accuracy. For options US150-ASB, US150-KS75-30, US150-KS75-36
US150DSB-HY	US150DSB-HY Beveling machine with dual hydraulic drive and dual bearing + regulation valve .Higher accuracy. For options US150-ASB, US150-KS75-30, US150-KS75-36

US150 E



ORDER NO.	DESCRIPTION
US150-24"	US150-24" Beveling machine with dual pneumatic drive and 24" kit
US150HY-SD-24"	US150HY-SD-24" Beveling machine with single hydraulic drive and 24" kit
US150HY-24"	US150HY-24" Beveling machine with dual hydraulic drive and 24" kit + regulation valve
US150DSB-24"	US150DSB-24" Beveling machine with dual pneumatic drive and dual bearing .Higher accuracy. For options US150-ASB, US150- KS75-30, US150-KS75-36
US150DSB-HY-SD-24"	US150DSB-24" Beveling machine with dual pneumatic drive and dual bearing .Higher accuracy. For options US150-ASB, US150- KS75-30, US150-KS75-36
US150DSB-HY-24"	US150DSB-HY-SD-24" Beveling machine with single hydraulic drive and dual bearing + regulation valve.Hhigher accuracy. For options US150-ASB, US150-KS75-30, US150- KS75-36



OD MOUNT MACHINING

Coating Removal



The US ID Clamping Beveling Machines can be equipped with optional accessories capable of machining the plastic coating of pipe, up to 130 mm (5") wall thickness.

All maintenance operations (cutting and beveling) can be performed at any place along the pipeline, removing the coating to provide space for the welding equipment.

Heating the coating at high temperature and removing it manually with a blade, or using machines with a waterjet cutting system (which damages the pipes) is no longer necessary. The machining of the coating with PROTEM equipment is the ideal solution.

PROTEM offers you professional solutions to perform machining operations on the job site safely, while getting perfect results.



■ US150

▼ OPTIONS :

Flange Facing Attachments



ORDER NO.	DESCRIPTION
US150-ASB	Flange facing attachment, for the remachining and resurfacing of worn or damaged flanges with diameters ranging from 165 mm ID up to 900 mm OD (6.5" ID – 35.4" AD)

Kit 24"

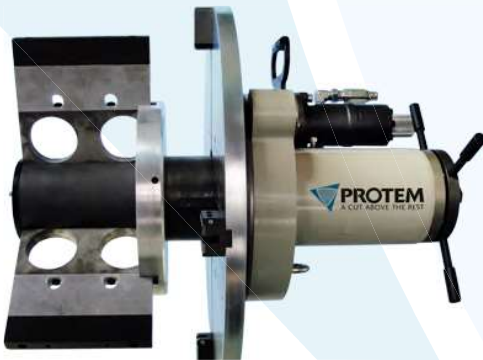

ORDER NO.	DESCRIPTION
US150-Kit 24"	Kit 24" for the US150: tool holder plate for diameters up to 24"; has to be ordered with a special crate.

Kit for Elbow



ORDER NO.	DESCRIPTION
US150-EMA	Elbow mandrel assembly for US150; diameters: 261 mm – 508 mm OD (10,276 – 20" OD)
US150-ASB-EMA1	Clamping spider for elbows. Allows an easy set up in tube, pipe or flange Capacity : 170 to 356 mm ID (6.700" to 14.400" ID)
US150-ASB-EMA2	Clamping spider for elbows. Allows an easy set up in tube, pipe or flange Capacity : 400 to 620 mm ID (15.700" to 24.400" ID)

Copying carriage



ORDER NO.	DESCRIPTION
US150-KS75-30	US150-KS75 copying carriage, stroke 75 mm up to 30" O.D. - Recommended with US150 DSB type machine. Incrementation via star wheel . Machining by copying via template/ cam.
US150-KS75-36	US150-KS75 copying carriage, stroke 75 mm up to 36" O.D. Recommended with US150 DSB type machine. Incrementation via star wheel . Machining by copying via template/ cam.

OD MOUNT MACHINING

▼ OPTIONS :

Bench support



ORDER NO.	DESCRIPTION
US150-OPT.5	Bench support for US150

ID-Tracker

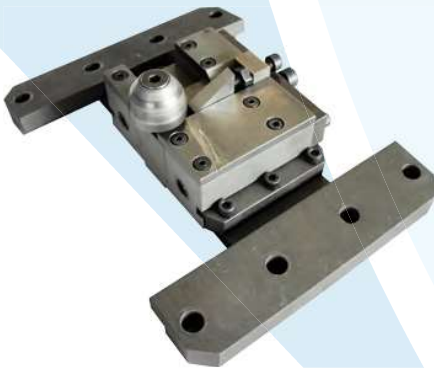

ORDER NO.	DESCRIPTION
US150-IDT	ID-Tracker: enables the US150 to maintain a consistent root land thickness independently of the pipe ovality or wall thickness variations.

Spider



ORDER NO.	DESCRIPTION
US150-SPY-20-30"	Spider assembly ranging from 20" to 30" (to be used with copying / flange facing carriages US150-KS75-30 and US150ASB)
US150-SPY-20-36"	Spider assembly ranging from 20" to 36" (to be used with copying / flange facing carriages US150-KS75-36 and US150ASB)

ORDER NO.	DESCRIPTION
US150-KS.S	US150-KS.S Cam for compound bevel or J-bevel (for bevel profile - 75 mm long - 40 mm high). Used with options US150- KS75-30 and US150-KS75-36
US150-KS.S1	US150-KS.S1 Cam for simple bevel (for bevel profile - 75 mm long - 40 mm high). Used with options US150-KS75-30 and US150-KS75-36

ORDER NO.	DESCRIPTION
US150-K01	crate for US150
US150-K02	Crate for US150 with kit 24"